

THERMACUT® REPLACEMENT PARTS SUITABLE FOR
Hypertherm®
HT® 4000
PAC® 170/PAC® 600

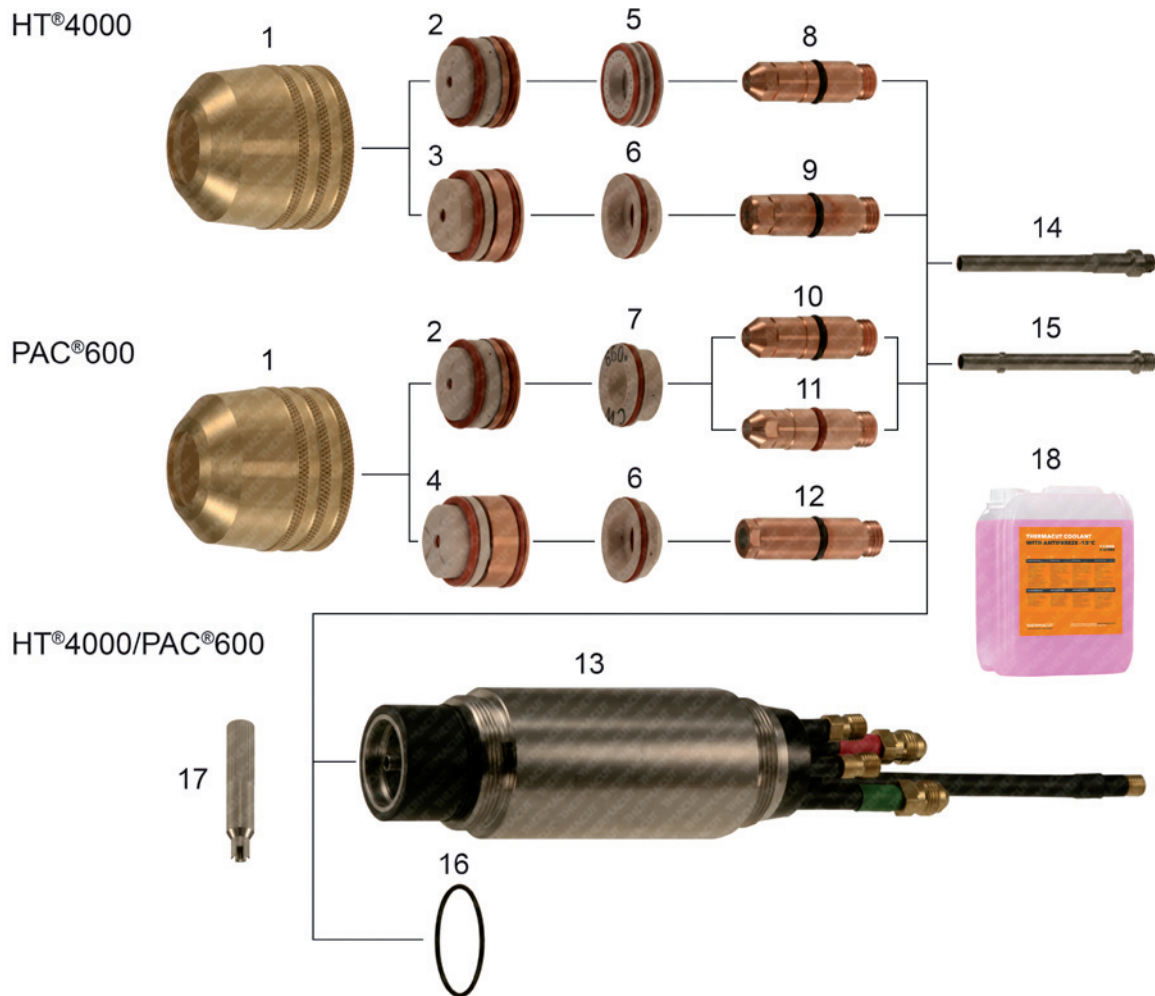

Item	Part No.	Ref. No.	Description	Std. Pkg.	Item	Part No.	Ref. No.	Description	Std. Pkg.
1.	T-0088	020579	Retaining Cap	1	8.	T-1293	020663	Electrode PAC®170, O ₂	5
2.	T-0078	020086	Nozzle 260A, 340A, O ₂	1	9.	T-0084	020082	Electrode, N ₂	5
3.	T-0080	020084	Nozzle .166, N ₂	1	10.	T-0083	020081	Electrode, O ₂	5
4.	T-0509	020281	Nozzle .120, N ₂	1	11.	T-1382	120090	Electrode, O ₂	5
	T-0510	020282	Nozzle .166, N ₂	1	12.	T-0499	020285	Electrode, N ₂	5
	T-0511	020283	Nozzle .187, N ₂	1	13.	T-1393	020328	Torch Body PAC®170/PAC®600/PAC®620	1
	T-0512	020284	Nozzle .220, N ₂	1	#14.	T-1389#	020990 OEM	Water Tube, OEM Torch	1
5.	T-1292	020623	Swirl Ring, PAC®170	1	**15.	T-1388**	020990-UR	Water Tube, TMT Torch	1
	T-2927	120015	Swirl Ring, Bevel, CCW	1	16.	T-1006	044028	O-Ring	1
6.	T-0020	020039	Swirl Ring .120/.166/.187, N ₂	1	17.	T-1397	T-1397	Wrench for TMT Water Tube	1
7.	T-1002	020380	Swirl Ring .099	1	18.			Coolant Liquid. Details on the page 152, section Accessories.	
	T-1003	020391	Swirl Ring .099, CCW	2					

COMPATIBLE WITH OEM TORCH ONLY, DOESN'T FIT TO THERMACUT TORCH

** COMPATIBLE WITH THERMACUT AND OEM TORCH

CCW COUNTER CLOCK WISE GAS SWIRLING, USE OF CCW PARTS WILL MAKE CUT ANGLE ON THE OPPOSITE SIDE, THAN WITH STANDARD CLOCK WISE (CW) SWIRLING PARTS.

Last update of this page: 11/04/2016. See Revision history for details.

THERMACUT®
 THE CUTTING COMPANY™

WWW.THERMACUT.CZ
 TEL.: +420.556.423.418
 SALES@THERMACUT.CZ

WWW.THERMACUT.DE
 TEL.: +49 (0) 27 39 40 33 0
 INFO@THERMACUT.DE

WWW.THERMACUT.COM
 TEL.: 1-603-542-6715
 CUSTOMERSERVICE@THERMACUT.COM

THERMACUT®, THE CUTTING COMPANY®, FHT-EX®, EX-TRAFIRE®, EX-TRACK®, EX-TRABEAM® AND EX-TRAFAME® ARE REGISTERED TRADEMARKS OF THERMACUT, K.S. AND MAY BE REGISTERED IN CZECH REPUBLIC AND/OR OTHER COUNTRIES. ALL OTHER TRADEMARKS ARE PROPERTIES OF THEIR RESPECTIVE OWNERS. THERMACUT IS NO WAY AFFILIATED WITH Hypertherm®.
 MOST THERMACUT PARTS ARE MADE FOR OR BY AN IBG COMPANY. PARTS INDICATED WITH A OEM ARE ORIGINAL PARTS MANUFACTURED BY THE ABOVE NAMED MANUFACTURER AND ARE BEING RESOLD BY THERMACUT. THERMACUT RESERVES THE RIGHT TO SUBSTITUTE OEM PARTS IN PLACE OF THERMACUT PARTS.
 VALID FROM NOVEMBER 2020 • PREVIOUS VERSION IS NO LONGER VALID. • © COPYRIGHT 2020 BY THERMACUT® CZECH REPUBLIC. ALL RIGHTS RESERVED.