

**THERMACUT® REPLACEMENT PARTS SUITABLE FOR
Hypertherm®
PAC®500
MODEL 500®**

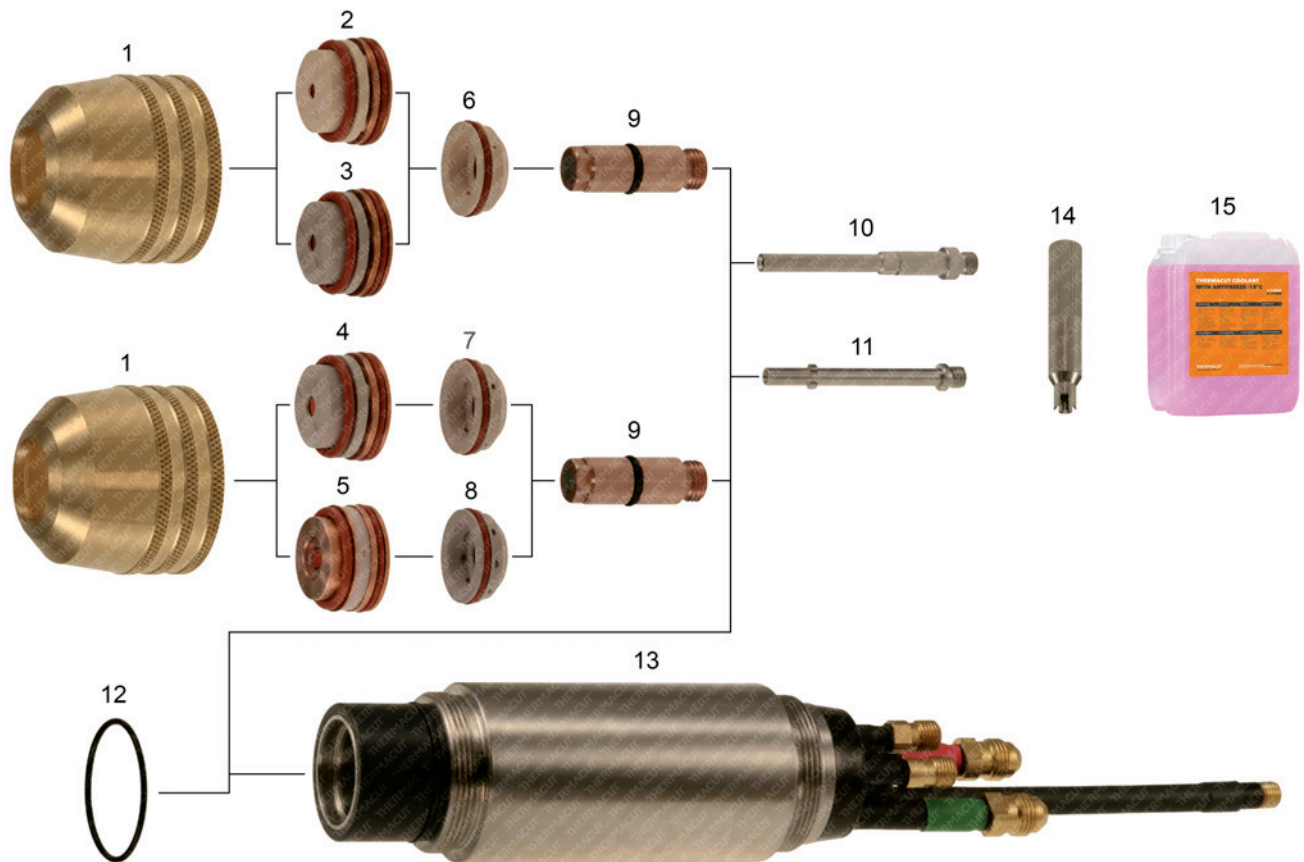

Item	Part No.	Ref. No.	Description	Std. Pkg	Item	Part No.	Ref. No.	Description	Std. Pkg
1.	T-0014	020034	Cap, Nozzle Retaining, Tapered	1	14.	T-1397	T-1397	Wrench for TMT Water Tube	1
2.	T-0016	020035	Nozzle .166	1	NS	KT-1214	028139	HT®400, PAC®500 Cable Leads 6.1m (20')	1
3.	T-0017	020036	Nozzle .187	1	NS	KT-1154	028140	HT®400, PAC®500 Cable Leads 7.6m (25')	1
4.	T-0018	020037	Nozzle .220	1	NS	KT-1157	028141	HT®400, PAC®500 Cable Leads 9.2m (30')	1
5.	T-0019	020047	Nozzle .250	1	NS	KT-1153	028142	HT®400, PAC®500 Cable Leads 10.7m (35')	1
6.	T-0020	020039	Swirl Ring .120/.166/.187, N ₂	1	NS	KT-1404	028143	HT®400, PAC®500 Cable Leads 12.2m (40')	1
7.	T-0021	020042	Swirl Ring .166, .187, CCW	1	NS	KT-1217	K.HT400.15,2M.K	HT®400, PAC®500 Cable Leads 15.2m (50')	1
8.	T-0022	020040	Swirl Ring .220	1	NS	KT-1471	K.PAC500.6,1M	PAC®500 Mach. Torch with Leads 6.1m (20')	1
	T-0023	020048	Swirl Ring .250	1	NS	KT-1165	K.PAC500.15,2M	PAC®500 Mach. Torch with Leads 15.2m (50')	1
9.	T-0024	020038	Electrode	5	NS	KT-1164	K.PAC500.22,9M	PAC®500 Mach. Torch with Leads 22.9m (75')	1
#10.	T-0598#	120035 OEM	Water Tube, OEM Torch	1	15.	Coolant Liquid. Details on the page 152, section Accessories.			
11.	T-1395	120035-UR	Water Tube, TMT Torch	1	Different types of cable leads available on request				
12.	T-1013	025028	O-Ring	1					
13.	T-0025	020030	Torch Main Body PAC®500	1					

- # COMPATIBLE WITH OEM TORCH ONLY, DOESN'T FIT TO THERMACUT TORCH
 ** COMPATIBLE WITH THERMACUT AND OEM TORCH
 NS NOT SHOWN IN THE PICTURE

Last update of this page: 15/02/2018. See Revision history for details.

THERMACUT®
THE CUTTING COMPANY

WWW.THERMACUT.CZ
TEL.: +420 556 423 418
SALES@THERMACUT.CZ

WWW.THERMACUT.DE
TEL.: +49 (0) 27 39 40 33 0
INFO@THERMACUT.DE

WWW.THERMACUT.COM
TEL.: 1-603-542-6715
CUSTOMERSERVICE@THERMACUT.COM

THERMACUT®, THE CUTTING COMPANY®, FHT-EX®, EX-TRAFIRE®, EX-TRACK®, EX-TRABEAM® AND EX-TRAFAME® ARE REGISTERED TRADEMARKS OF THERMACUT, K.S. AND MAY BE REGISTERED IN CZECH REPUBLIC AND/OR OTHER COUNTRIES. ALL OTHER TRADEMARKS ARE PROPERTIES OF THEIR RESPECTIVE OWNERS. THERMACUT IS NO WAY AFFILIATED WITH Hypertherm®.
 MOST THERMACUT PARTS ARE MADE FOR OR BY AN IBC COMPANY. PARTS INDICATED WITH A OEM ARE ORIGINAL PARTS MANUFACTURED BY THE ABOVE NAMED MANUFACTURER AND ARE BEING RESOLD BY THERMACUT. THERMACUT RESERVES THE RIGHT TO SUBSTITUTE OEM PARTS IN PLACE OF THERMACUT PARTS.
 VALID FROM NOVEMBER 2020 • PREVIOUS VERSION IS NO LONGER VALID. • © COPYRIGHT 2020 BY THERMACUT® CZECH REPUBLIC. ALL RIGHTS RESERVED.